

POIGNEE PORTE *GIORGIA 169* DESIGN VITTORE BIANCHI

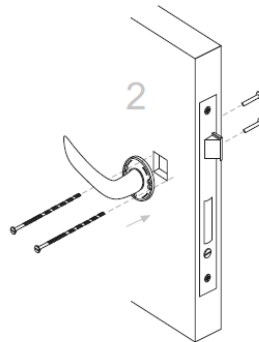

MATERIAU :

ZAMAK

SOUS CONSTRUCTION :

POLYAMIDE RENFORCE

FIBRE DE VERRE

RESSORT DE RAPPEL

CARRE SERRURE :

7 POUR POIGNEE

6 POUR WC

FIXATION :

INVISIBLE TRAVERSANTE

FIXATION ROSACE :

PAR CLIPSAGE

FINITIONS :

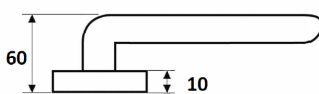
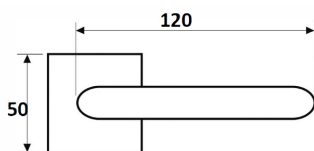

CHROME SAT

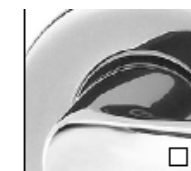

CHROME POLI

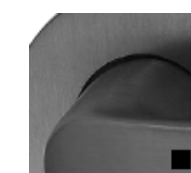

LAQUE NOIR

TYPE FERMETURE

CLE L/EURO



CLE I /PZ



WC



REFERENCE CARREE

set 169-211b EURO

set 169-211 b PZ

set 169-211b WC

OPTIONS :

- PALIERE AVEC BOUTON 306

- CARRE 8

- BUTEE DE PORTE

- SERRURE MAGNETIQUE